

# ELECTRICAL LIGHTING KIT

Add on  
All **XPERT** tents

ALPINTER 

# SETUP INSTRUCTIONS

V3.6

24 m<sup>2</sup>



Nr. S9999999  
UN46530075

36 m<sup>2</sup>

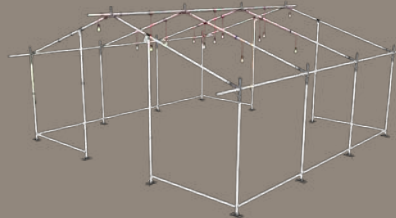

Nr. S9999999  
UN46530076

48 m<sup>2</sup>

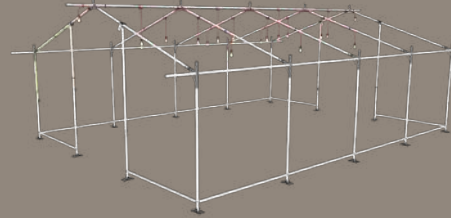

Nr. S9999999  
UN46530085

72 m<sup>2</sup>

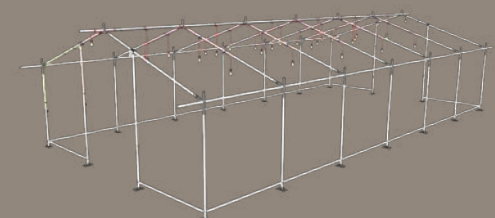

Nr. S9999999  
UN 46530095

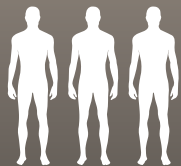

Needed to assemble







Production date: See box

<https://www.alpinter.com/download/>

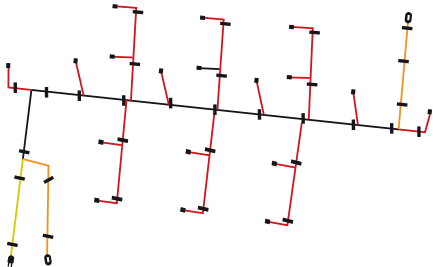
SET UP INSTRUCTION  
HERE



# 1. CONTENT

<b>XPERT</b> tents		<b>XPERT CONNECT</b> tents		24 m <sup>2</sup>	36 m <sup>2</sup>	48 m <sup>2</sup>	72 m <sup>2</sup>
<b>U</b>	CABLE WITH SOCKET, PLUGS AND SWITCHES (WITH RIP-TIE) 			<b>1x</b>	<b>1x</b>	<b>1x</b>	<b>1x</b>
<b>V</b>	POWERSTRIP 4 SOCKET WITH 30 MA PROTECTION < 30 MS 5 M CABLE - IP44 			<b>1x</b>	<b>1x</b>	<b>1x</b>	<b>1x</b>
<b>S</b>	LED BULB 9 W/220 V - E27 - 800 LM 			<b>2x</b>	<b>2x</b>	<b>2x</b>	<b>2x</b>
<b>W</b>	LED BULB 13 W/220 V - E27 - 1400 LM 			<b>6x</b>	<b>11x</b>	<b>16x</b>	<b>26x</b>
	POWER EXTENSION CORD - 5 M 			<b>1x</b>	<b>1x</b>	-	-
	POWER EXTENSION CORD - 10 M 			-	-	<b>1x</b>	<b>1x</b>

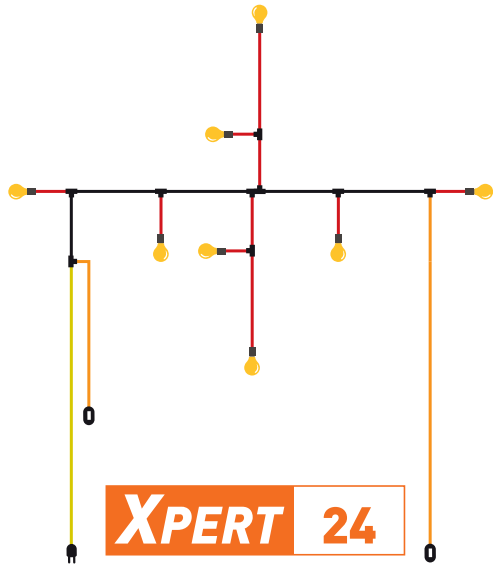

**XPERT 24**

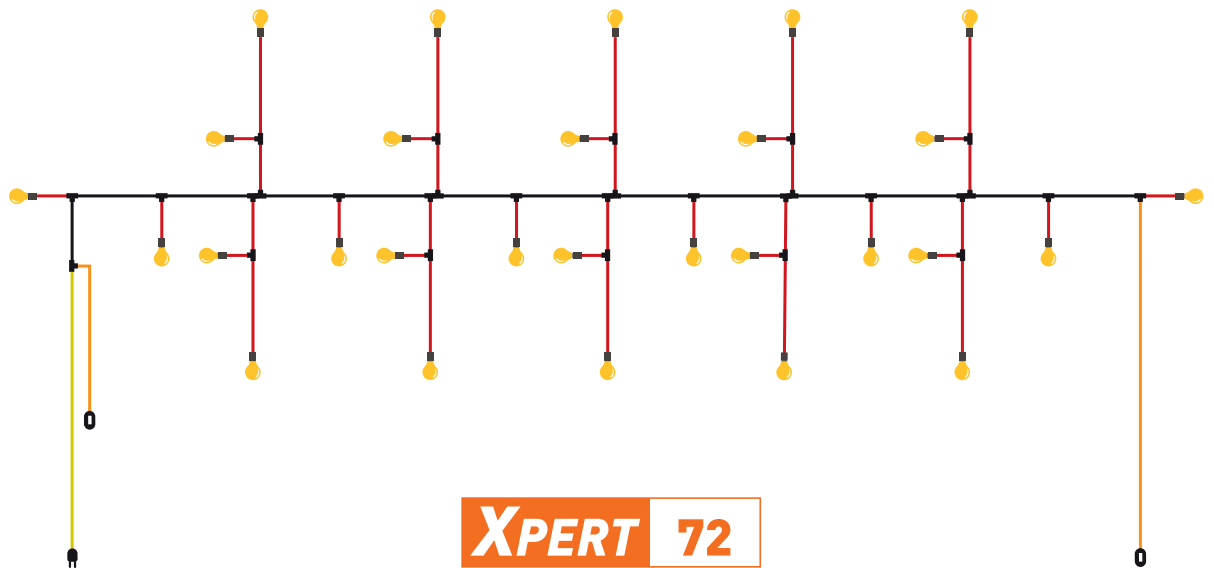

**XPERT 72**

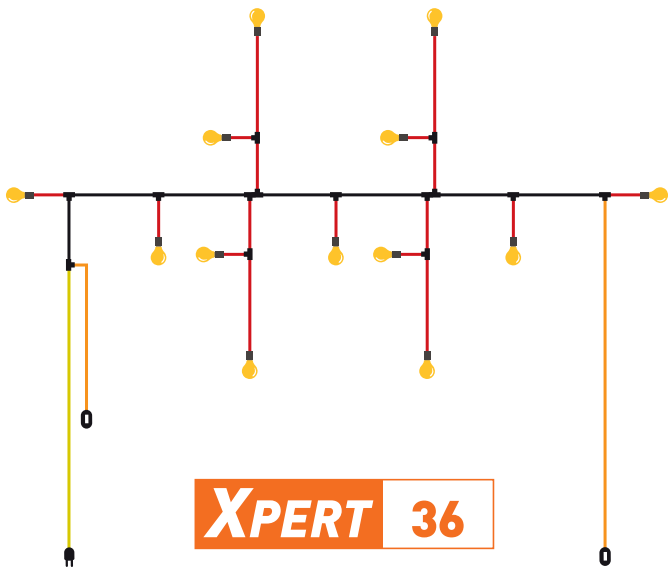

**XPERT 36**

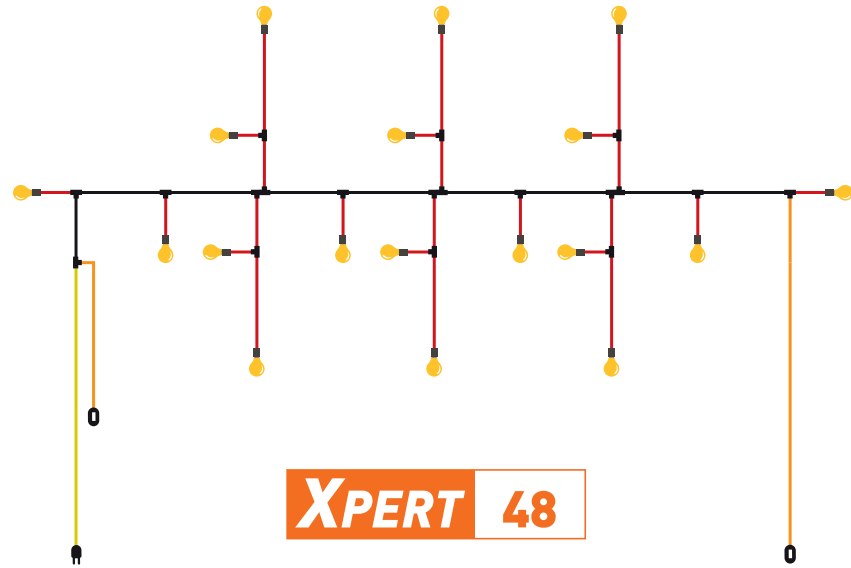

**XPERT 48**

## 2.

# SETUP INSTRUCTIONS

## 01

**ELECTRICAL LIGHTING KIT**  
Add on All **XPERT tents**

**STEP 1/2**

This setup instruction is an example, based on the setup of the Electrical Lighting Kit for XPERT tent 48m2. Electrical Lighting Kits for other models (XPERT CONNECT or other tent sizes) can be set up following the same steps.

**PLACE the lighting kit on the ground, in the correct position under the frame.**

**MAIN ENTRANCE**

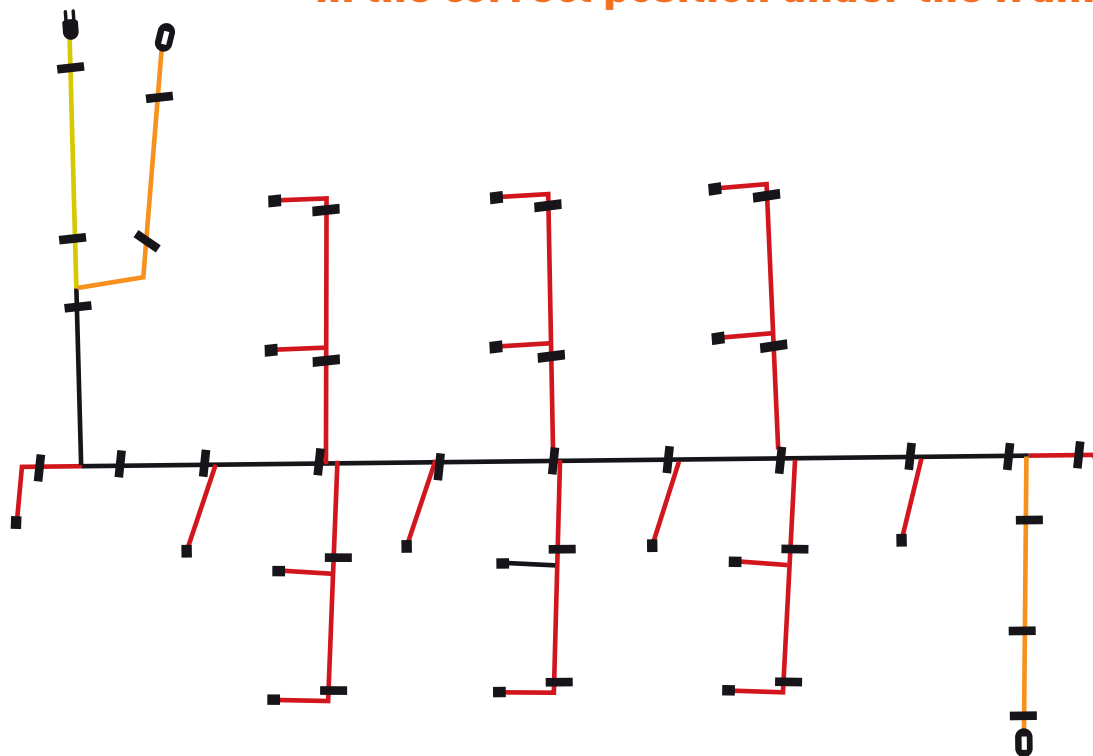

**REAR**

## 02

Attach all RIP-Tie cable wraps to the **FRAME**.  
**START** at **CENTER** of the **RIDGE**,  
continue attaching Rip-Ties  
to the ridge and roof poles.  
Finish with plug and switch cable.

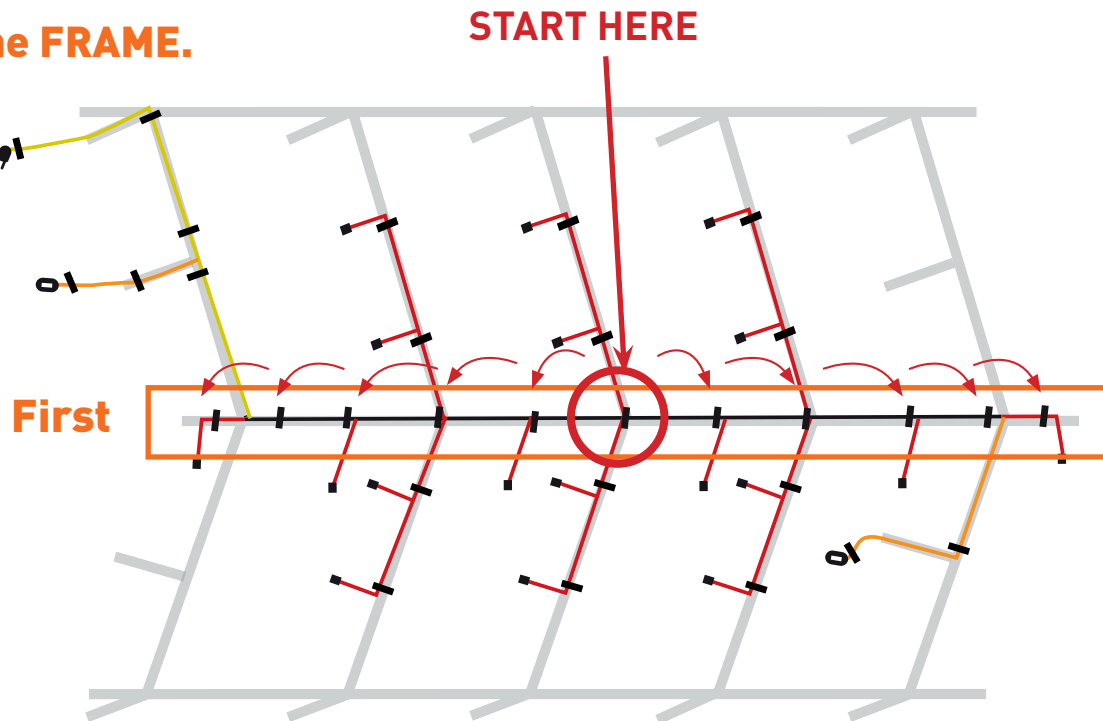
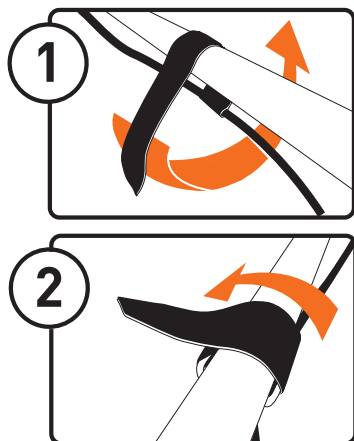

Example of XPERT 48 Electrical Lighting Kit

## 03

Go back to your

**XPERT** tents  
TENT SETUP MANUAL

Or continue this setup if your tent is already  
built.

## 03 bis

If you have

**INNER LINER** or **WINTER LINER**  
Add on **All XPERT** tents

Go back to your add-on setup instruction.

Example of XPERT 48 Electrical Lighting Kit



**Attach remaining STRAPS to the FRAME**

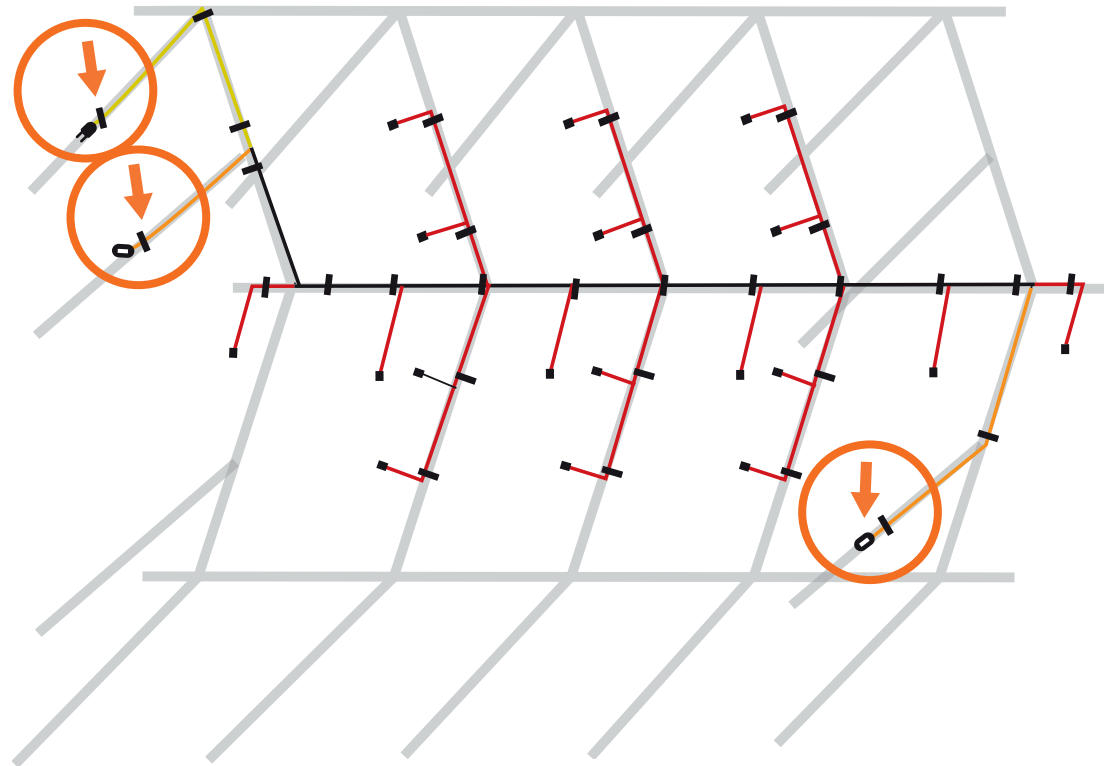

**Screw in BULBS**

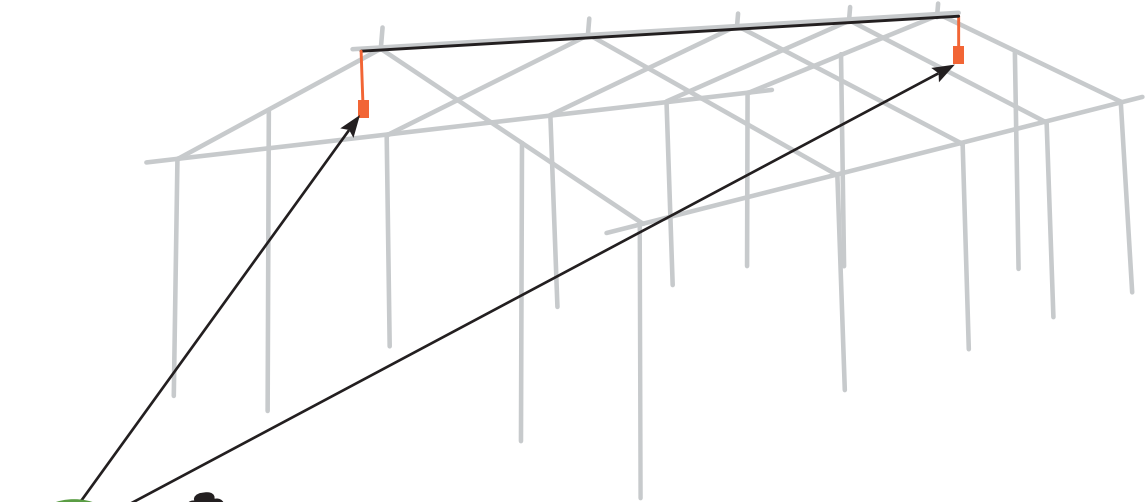

**S**  **2 X outside the tent**

**and all** **W**  **inside the tent**

Example of XPERT 48 Electrical Lighting Kit

06

Connect to the grid

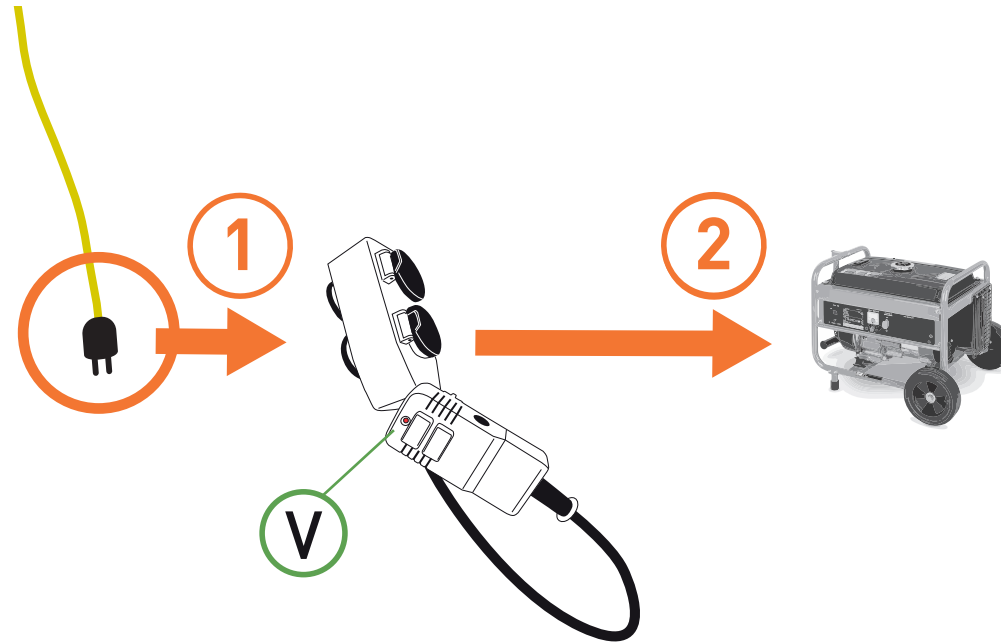

07

Go back to your **XPERT tents** to finalise you tent setup.  
TENT SETUP MANUAL



### 3.

## AVAILABLE TENT ADD-ONS FOR XPERT Tents

### INNER LINER

Add on All **XPERT** tents

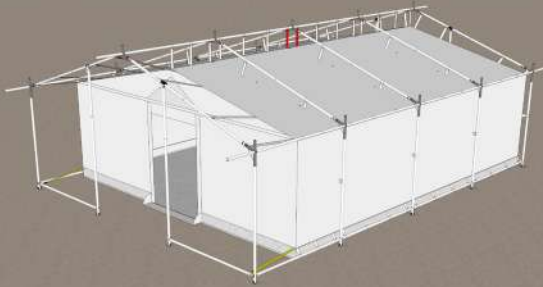

### WINTER LINER

Add on All **XPERT** tents

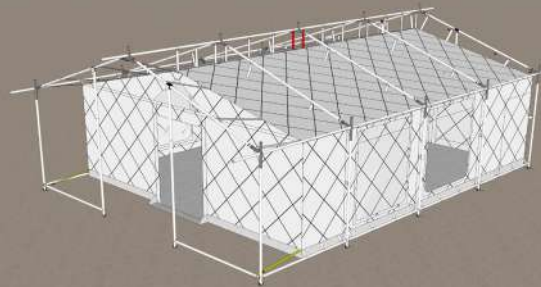

### SOLAR LIGHTING KIT

Add on All **XPERT** tents



### ELECTRICAL LIGHTING KIT

Add on All **XPERT** tents

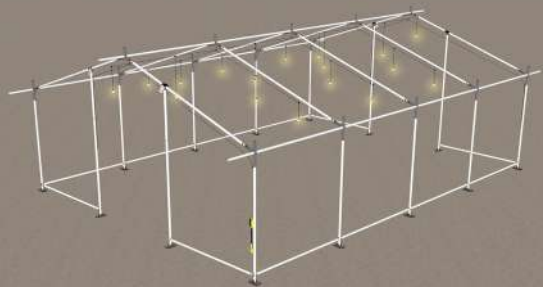

### HARD FLOOR

12 SQM set

Add on All **XPERT** tents

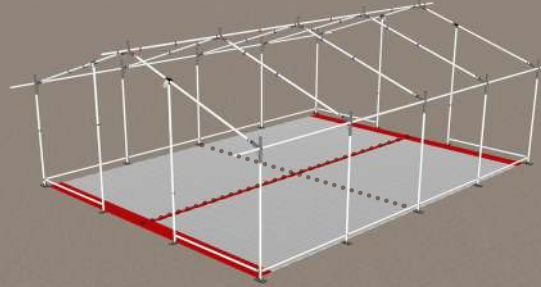

2 x **HARD FLOOR** 12 SQM set Add on All **XPERT** tents = 24 m<sup>2</sup>

3 x **HARD FLOOR** 12 SQM set Add on All **XPERT** tents = 36 m<sup>2</sup>

4 x **HARD FLOOR** 12 SQM set Add on All **XPERT** tents = 48 m<sup>2</sup>

6 x **HARD FLOOR** 12 SQM set Add on All **XPERT** tents = 72 m<sup>2</sup>

### 3.

## AVAILABLE TENT ADD-ONS FOR XPERT Tents

### CROSS CONNECTION

Add on  
Only **XPERTCONNECT** tents

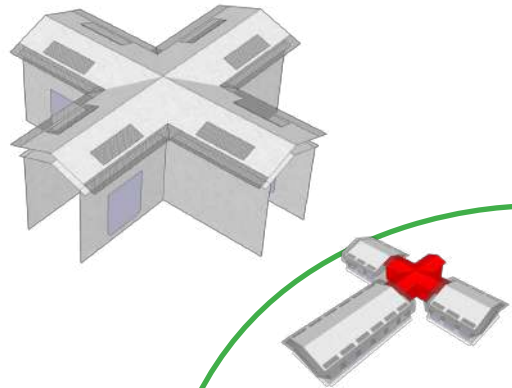

### CONNECTOR

Add on  
Only **XPERTCONNECT** tents

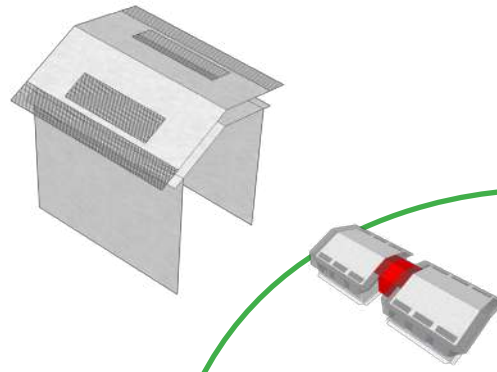

### WINTER CABIN

Add on  
All **XPERT** tents

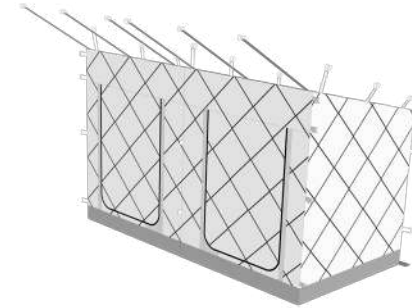

### WC / SHOWER CABIN

Add on  
All **XPERT** tents

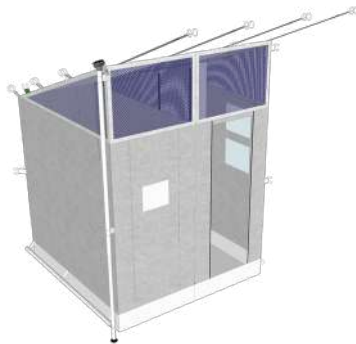

### SEPARATION CURTAIN

Add on  
All **XPERT** tents

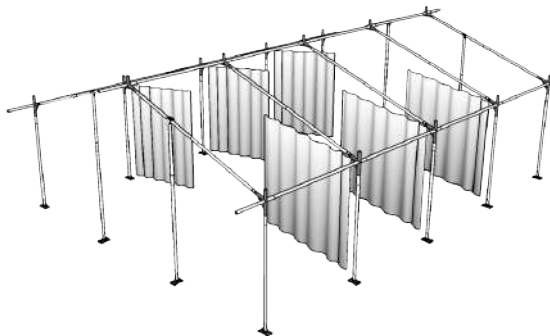

### MESH ROOF SET

Add on  
All **XPERT** tents





#### HEAD OFFICE

##### **ALPINTER BELGIUM**

CHARLES DE GAULLESTR. 7  
B-9600 RENAIX - RONSE | BELGIUM | **EUROPE**  
Tel: +32 (0)55 23 17 54

#### REGIONAL OFFICES

##### **ALPINTER BULGARIA**

35-37 KLOKOTNITZA ST | AP.1  
1233 | SOFIA  
BULGARIA

##### **ALPINTER DUBAI**

INTERNATIONAL HUMANITARIAN CITY  
BUILDING N° 1 | SECOND FLOOR | OFFICE 207  
DUBAI INDUSTRIAL CITY | PO BOX 506047  
DUBAI | U.A.E. | **MIDDLE EAST**

##### **ALPINTER UGANDA**

PLOT 224-226, KYEYUNE ROAD | KIGGUNDU ZONE  
KANSANGA | PO BOX 25525  
KAMPALA | UGANDA | **EAST AFRICA**

##### **ALPINTER ASIA**

ALPINTER ASIA LTD.  
RM 1902, HUA FU COMMERCIAL BLD.  
111 QUEENS ROAD WEST  
SHEUNG WAN | HONG KONG | **ASIA**

#### PRODUCTION SITE & PARTNER



info@alpinter.com | [www.alpinter.com](http://www.alpinter.com)